

USE ANCHOR BOLTS

KPARK-SIGN-2



23 ch. Boom Lane, Unit/Unité E Industrial
 Park/Parc industriel Atholville, New/Nouveau-
 Brunswick Canada, E3N 4E8
 Tel/tél. : 1-888-212-1411/Fax/télé. : 1-888-
 789-0987 www.kangaroo.com

Approval date: 13-08-21
 Rev: 00
 Initial: AK

ITEM-A
QTY-2

MATERIAL- SQUARE STEEL TUBING 2x2"



ITEM-B
QTY-4

MATERIAL- SQUARE STEEL TUBING 2x2"

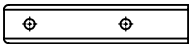

ITEM-C
QTY-1

MATERIAL- SQUARE STEEL TUBING 2x2"



KPARK-SIGN-2
FRAME
LASER CUT

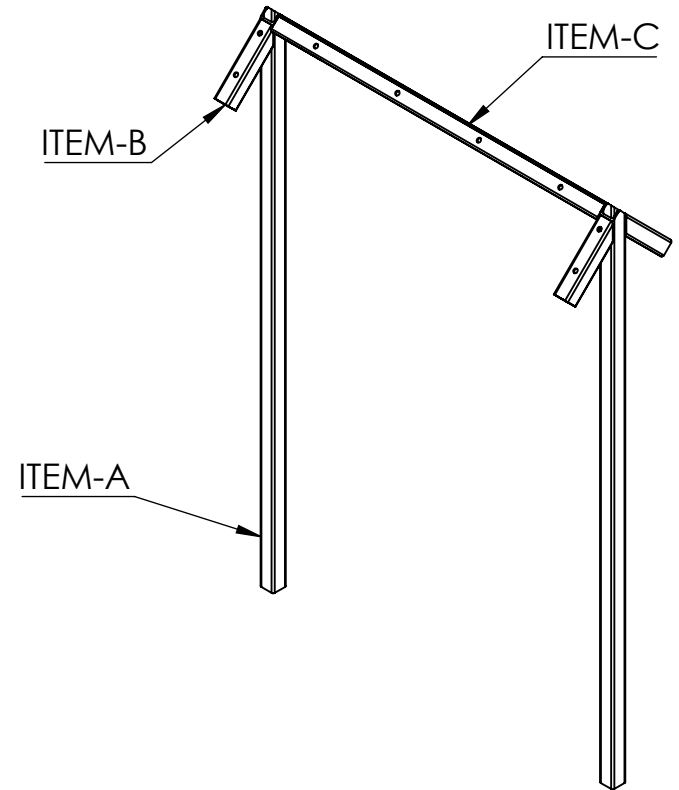

ITEM-D

QTY-2

MATERIAL- STEEL PLATE 3/16"

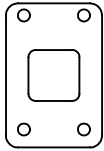

KANBAN
ITEM-ACT-B
QTY-4

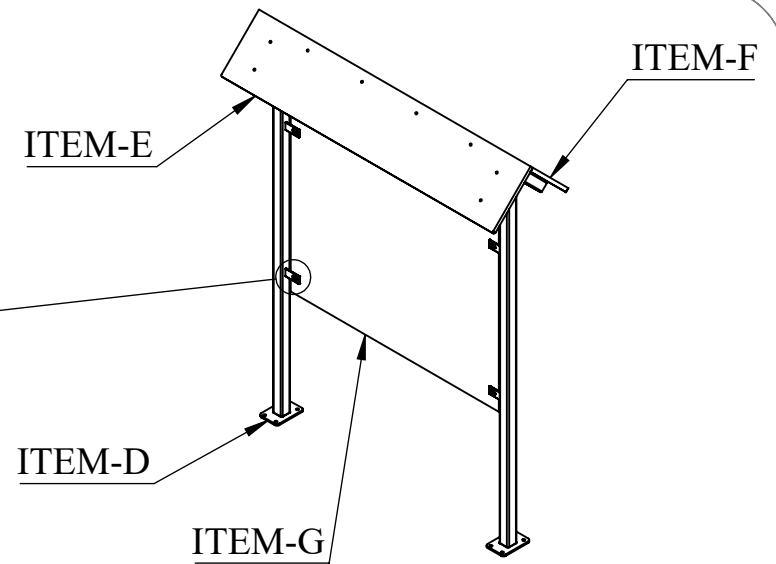
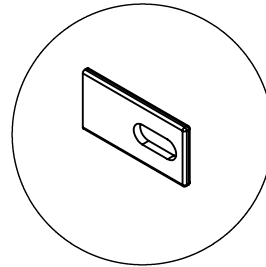

ITEM-E

QTY-1

MATERIAL- HDPE PLASTIC 3/4"

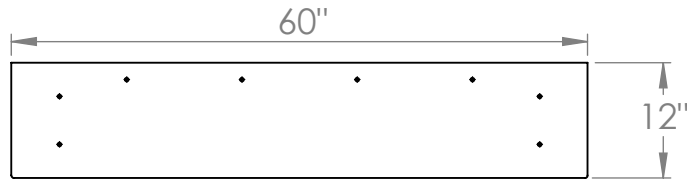

ASSEMBLY
ITEM-E&F

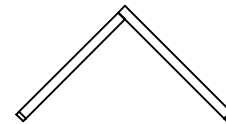

ITEM-G
QTY-1

MATERIAL- HDPE PLASTIC 3/4"



ITEM-F

QTY-1

MATERIAL- HDPE PLASTIC 3/4"

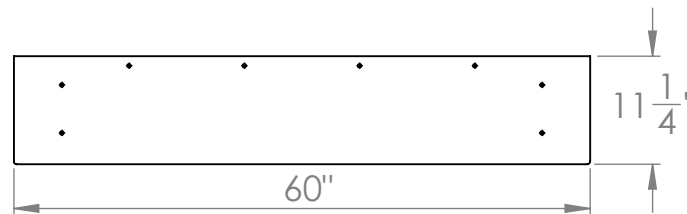

WELDING POSITIONS

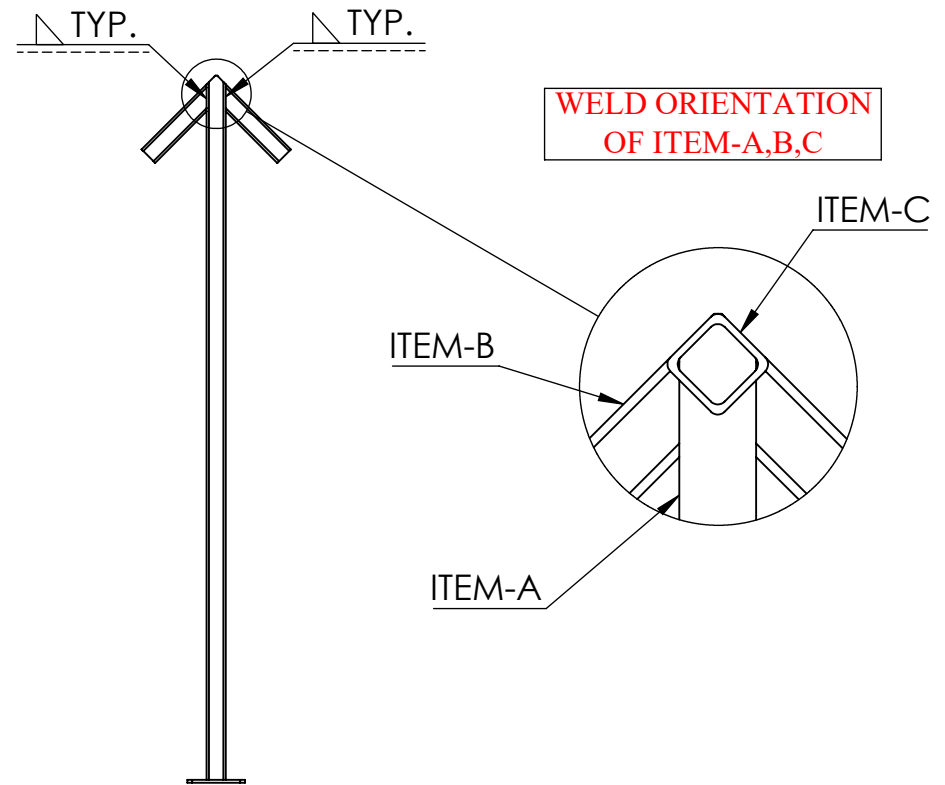
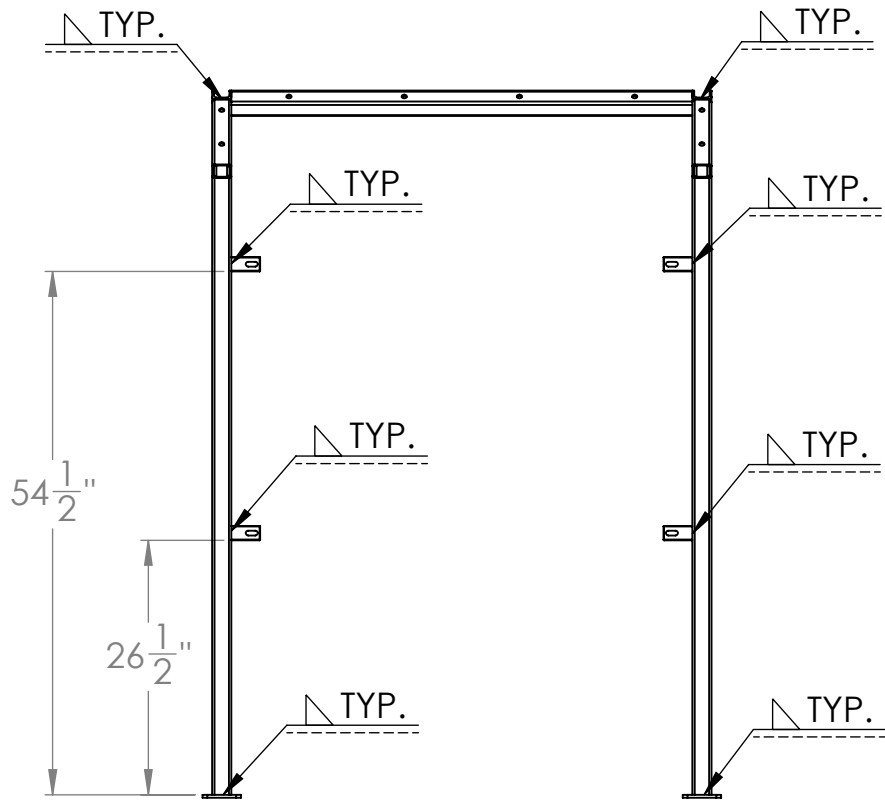

KPARK-SIGN-2



23 ch. Boom Lane, Unit/Unité E Industrial
 Park/Parc industriel Atholville, New/Nouveau-
 Brunswick Canada, E3N 4E8
 Tel/tél. : 1-888-212-1411/Fax/télec. : 1-888-
 789-0987 www.kangaroo.com

Approval date: 13-08-21
 Rev: 00
 Initial: AK